

|       |         |          |    |                |                  |           |         |
|-------|---------|----------|----|----------------|------------------|-----------|---------|
| Name  | 下高章     | Temp     | °C | Engine         | OS 12XZ Spec III | Muffler   | T-1070  |
| Date  | 2012.12 | Humidity | %  | Head Clearance | mm               | Fuel Type | コスモ 16% |
| Track | BOSS    | Traction | %  | Plug No.       | RP.6             | Radio     | Futaba  |

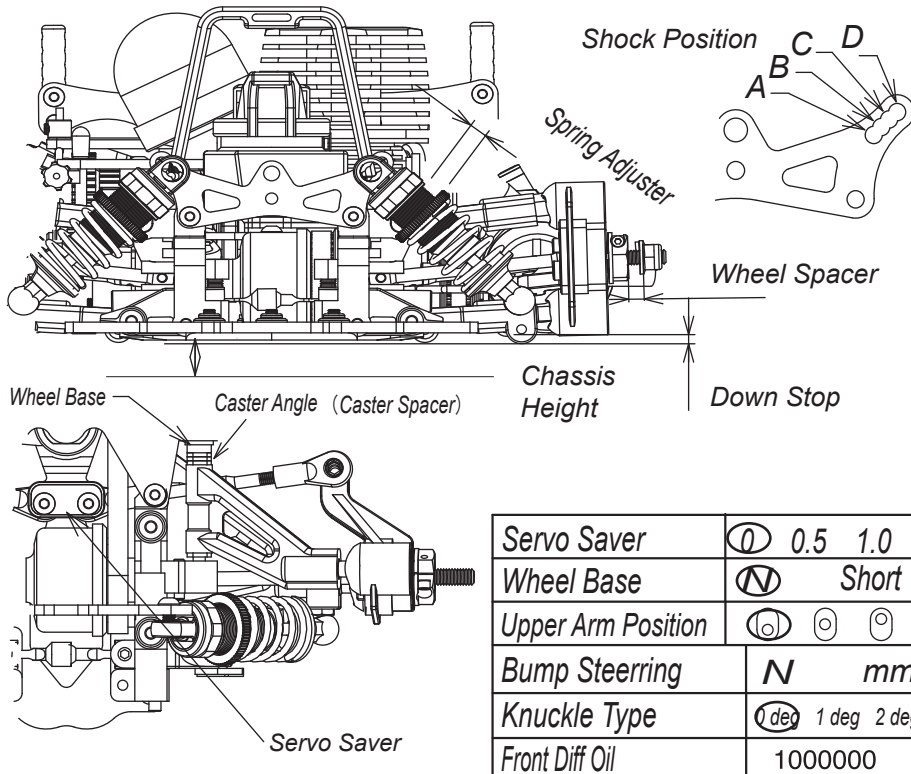

|                       |  |
|-----------------------|--|
| Shock Oil             | 300 350 400 450 <b>500</b> 550 600 700 800                   |
| Diaphragm             | Ⓝ  |
| Shock Piston          | Ⓝ  |
| Spring                | Blue   |
| Spring Adjuster       | mm   |
| Shock Position        | Ⓐ B C D  |
| Caster Angle (Spacer) | 3 mm   |
| Camber Angle 0G/1G    | L 0 0.5 <b>①</b> 1.5 2 2.5 3<br>R 0 0.5 <b>①</b> 1.5 2 2.5 3 |
| Toe Angle             | -1.2 deg   |
| Front Width           | 199 mm   |
| Down Stop             | -1 mm  |
| Wheel Spacer          | 0 mm   |
| Servo Saver           | ⓪ 0.5 1.0  |
| Wheel Base            | Ⓝ Short  |
| Upper Arm Position    | ⓪ ① ②  |
| Bump Steering         | N mm   |
| Knuckle Type          | ⓪ deg 1 deg 2 deg  |
| Front Diff Oil        | 100000   |
| Antiroll Bar          | VZ084SS Super Soft / VZ084S Soft / Sway(φ) Bar mm            |
| Tire                  | ZBB-812CSH / deg   |
| Wheel Offset Type     | mm   |
| Tire Diameter         | φ 63 mm  |
| Chassis Height        | 8 mm   |
| Used Optional parts   |  |

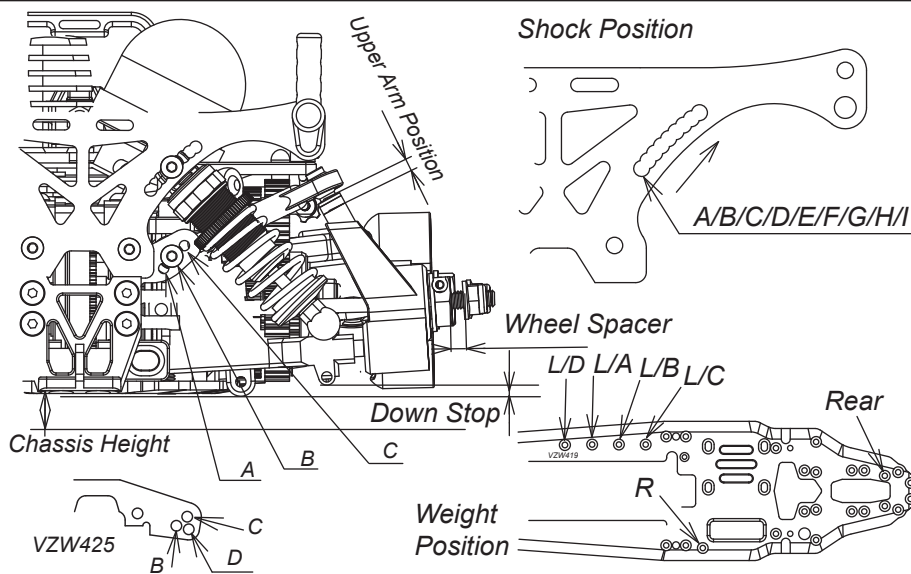

|                    |  |
|--------------------|--|
| Shock Oil          | 300 350 400 450 <b>500</b> 550 600 700 800                               |
| Diaphragm          | Ⓝ  |
| Shock Piston       | Ⓝ  |
| Spring             | Yellow   |
| Spring Adjuster    | mm   |
| Shock Position     | A Ⓝ B C / D / E / F / G / H / I  |
| Wheel Spacer       | mm   |
| Upper Arm Position | 2 mm 外下 A / B / C <b>④</b>   |
| Camber Angle 0G/1G | L 0 0.5 <b>①</b> 1.5 2 2.5 3 3.5 4<br>R 0 0.5 <b>①</b> 1.5 2 2.5 3 3.5 4 |
| Toe Angle          | 3 deg  |
| Rear Width         | 199.5 mm   |
| Down Stop          | -1 mm  |
| Antiroll Bar       | Ⓝ 2 mm   |
| Tire               | ZBB-9121SH / deg   |
| Wheel Offset Type  | mm   |
| Tire Diameter      | φ 65 mm  |
| Chassis Height     | 9 mm   |

| Gear | Total | Gear | Total | Gear | Total | Gear | Total | Gear | Total | Gear | Total |
|------|-------|------|-------|------|-------|------|-------|------|-------|------|-------|
| 16   | 61    | 7.63 | 16    | 60   | 7.50  | 16   | 59    | 7.38 | 21    | 56   | 5.33  |
| 17   | 61    | 7.18 | 17    | 60   | 7.06  | 17   | 59    | 6.94 | 22    | 56   | 5.09  |
|      |       |      |       |      |       |      | 59    |      | 23    | 56   | 4.87  |
|      |       |      |       |      |       |      |       |      | 23    | 55   | 4.78  |
|      |       |      |       |      |       |      |       |      | 23    | 54   | 4.69  |

|                    |                                  |               |   |
|--------------------|----------------------------------|---------------|---|
| Clutch Type        | Ⓝ (VZW229)                       | Pinion Gear   | (15) <b>16</b> 7 / (20) 2 <b>22</b> 23      |
| Clutch Shoe        | N / VZW229-03Y Yellow            | Spur Gear     | <b>59</b> 60 61 <b>54</b> 55 56             |
| Clutch Weight      | Ⓝ / Other ( )                    | Drive Ratio   | 0mm Difference (24T Pully 387Belt)          |
| Clutch Spring      | N (φ1.7) / VZ446 <b>①</b> (φ1.8) |               | <b>2.5mm Difference</b> (23T Pully 384Belt) |
| Clearance          | 0.7 mm                           | Rear Diff Oil | 50000                                       |
| Adjust Nut         | 1.4 mm                           | Main Chassis  | N (VZ437) / VZW419                          |
| Lower Arm Position | ⓪ (ZERO) ⓪ (OUT 1mm)             | Weight        | L (A <b>Ⓝ</b> B C D) R / Rear               |
| Wheel Base         | Ⓝ Short                          | Body-Shell    | P-37N                                       |

Memo シャシー OP, フロントバンパー固定, リアデフ上 アルミ, リアユニバーサル アルミ, フロントボディマウント内側