

Name	Shimo	Temp	°C	Engine	OS 12XZ	Muffler	OS 1060
Date	2012/3/20	Humidity	%	Head Clearance	mm	Fuel Type	COSMO 16%
Track	HOKUSEI	Traction	%	Plug No.	RP6	Radio	Futaba 4PK S

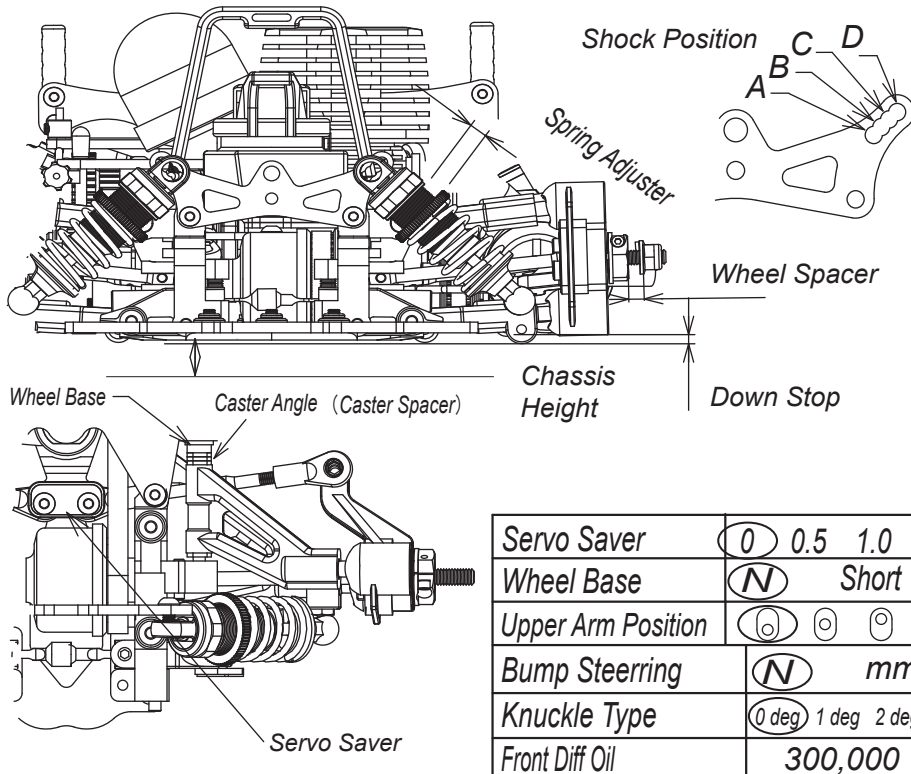

Shock Oil	300 350 400 450 <b>500</b> 550 600 700 800
Diaphragm	<b>(N)</b>
Shock Piston	<b>(N)</b>
Spring	VZW414-4017 イエロー
Spring Adjuster	- mm
Shock Position	<b>(A)</b> B C D
Caster Angle (Spacer)	3 mm
Camber Angle	L 0 0.5 <b>1</b> 1.5 2 2.5 3 R 0 0.5 <b>1</b> 1.5 2 2.5 3
Toe Angle	-1.0 deg
Front Width	198 mm
Down Stop	0 mm
Wheel Spacer	0 mm
Servo Saver	<b>(0)</b> 0.5 1.0
Wheel Base	<b>(N)</b> Short
Upper Arm Position	<b>(0)</b> <b>(1)</b> <b>(2)</b>
Bump Steering	<b>(N)</b> mm
Knuckle Type	<b>(0 deg)</b> 1 deg 2 deg
Front Diff Oil	300,000
Antiroll Bar	<b>(Z084SS Super Soft)</b> / Sway(φ) Bar (mm)
Tire	ZAC ZBB-811CCH
Wheel Offset Type	0 mm
Tire Diameter	φ 63 mm
Chassis Height	8 mm

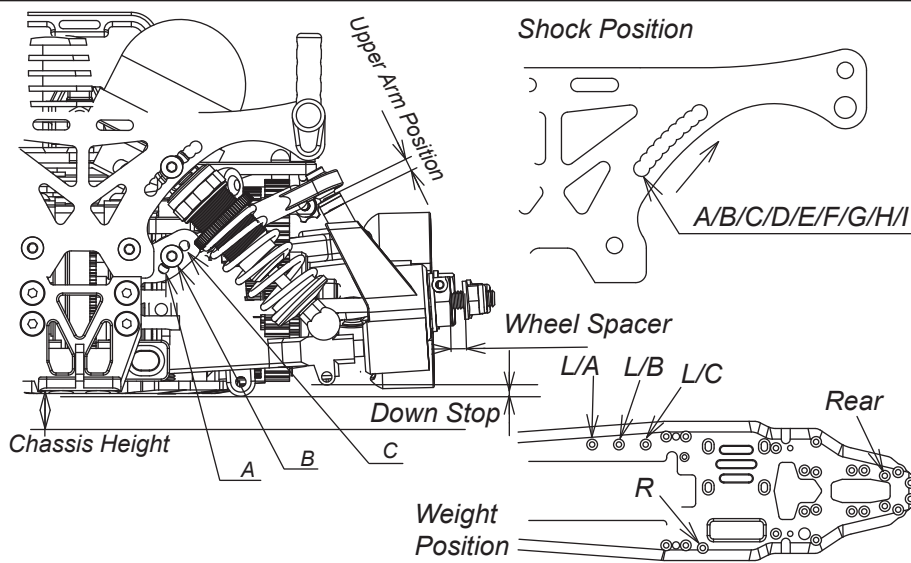

Shock Oil	300 350 400 450 <b>500</b> 550 600 700 800
Diaphragm	<b>(N)</b>
Shock Piston	<b>(N)</b>
Spring	SERPENT ORANGE
Spring Adjuster	- mm
Shock Position	<b>(A)</b> <b>(B)</b> C/D/E/F/G/H/I
Wheel Spacer	0 mm
Upper Arm Position	2 mm A <b>(B)</b> C
Camber Angle	L 0 0.5 1 1.5 2 2.5 3 3.5 4 R 0 0.5 1 1.5 2 2.5 3 3.5 4
Toe Angle	3.0 deg
Rear Width	199.5 mm
Down Stop	0 mm
Antiroll Bar	<b>(N)</b> 2.0 mm
Tire	ZAC ZBB9121CH
Wheel Offset Type	0 mm
Tire Diameter	φ 65 mm
Chassis Height	9 mm

Gear	Total	Gear	Total	Gear	Total	Gear	Total	Gear	Total	Gear	Total
16	61	7.63	16	60	7.50	16	59	7.38	21	56	5.33
17	61	7.18	17	60	7.06	17	59	6.94	22	56	5.09
				59		23	56	4.87	23	55	4.78
									23	54	4.69

Clutch Type	<b>(N)</b> VZW229	Pinion Gear	(15) 16 <b>(17)</b> (20) 21 <b>(22)</b> 23	Shock Oil	300 350 400 450 <b>500</b> 550 600 700 800
Clutch Shoe	<b>(Grey)</b> Other ( )	Spur Gear	59 60 <b>(61)</b> <b>(54)</b> 55 56	Diaphragm	<b>(N)</b>
Clutch Weight	<b>(N)</b> Other ( )	Drive Ratio	0mm Difference(24T Pully 387Belt) <b>(2.5mm Difference(23T Pully 384Belt))</b>	Shock Piston	<b>(N)</b>
Clutch Spring	VZ446 φ1.8	Rear Diff Oil	50,000	Spring	SERPENT ORANGE
Clearance	0.7 mm	Battery Plate	N (Carbon) / Other ( )	Spring Adjuster	- mm
Adjust Nut	1.5 mm			Shock Position	<b>(A)</b> <b>(B)</b> C/D/E/F/G/H/I
Memo	VZW419 SPメインシャシー使用			Wheel Spacer	0 mm
	VZW411 カーボンバンパープレートセット使用 (4ヶ所固定)			Upper Arm Position	2 mm A <b>(B)</b> C
				Camber Angle	L 0 0.5 1 1.5 2 2.5 3 3.5 4 R 0 0.5 1 1.5 2 2.5 3 3.5 4
				Toe Angle	3.0 deg
				Rear Width	199.5 mm
				Down Stop	0 mm
				Antiroll Bar	<b>(N)</b> 2.0 mm
				Tire	ZAC ZBB9121CH
				Wheel Offset Type	0 mm
				Tire Diameter	φ 65 mm
				Chassis Height	9 mm
				Lower Arm Position	<b>(0)</b> (ZERO) <b>(0)</b> (OUT 1mm)
				Weight	<b>(N)</b> / UP mm
				Wheel Base	<b>(N)</b> Short
				Body-Shell	PF P37Nmm