

Name: Shin Adachi Date: 17/Mar/2010 Truck / City: Yatabe Arena Event: _____

Front Suspension

Upper Spacer: 3 mm

King Pin: Standard UM128

Upper Spacer: 0.75 mm

Knuckle Spacer: Upper Lower

Wheel Spacer: 0.5 mm

Drive Hub: LAW30R (4.5) TFW031 (5.2)

Drop: 8.5 mm

Upper Rod Position:

Diff. Position:

Sus. Arm Spacer: Front 1 mm Rear 2 mm

Knuckle Spacer: 1 mm

Ride Height: 5.2 mm

Sway Bar: None

Toe Angle: 0.5 °

Front Diff.: Spool Oneway Diff.

Camber Angle: 2.0 °

Sus. Holder Bush: Front In / Out E

Sus. Holder Spacer: 1.5 mm

Rear In / Out E

Sus. Holder Spacer: 1.5 mm

Notes: _____

Rear Suspension

Upper Spacer: 1.75 mm

Upper Rod Position:

Upper Spacer: 0 mm

Wheel Spacer: 1.75 mm

Drive Hub: LAW30R (4.5) TFW031 (5.2)

Drop: 8 mm

Sus. Arm Spacer: Front 2 mm Rear 1 mm

Diff. Position:

Ride Height: 5.5 mm

Sway Bar: None

Hub Carrier Spacer: Front 1 mm Rear 1 mm

Camber Angle: 2 °

Sus. Holder Bush: Front IN / OUT D

Sus. Holder Spacer: 1.5 mm

Rear IN / OUT D

Sus. Holder Spacer: 1.5 mm

Shock

	Front	Rear
Shock Oil:	# 52.5 (LRP)	# 45 (LRP)
Shock Spring:	White (tamiya)	Blue (tamiya)
Diaphragm:	Std	Std
Pressure Form:	None	None
Shock Length:	_____ mm	_____ mm

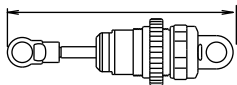

Steering Wiper

Steering Spacer: 2.5 mm

Chassis

Battery Position: IN OUT

Weight: 28 g

Weight: 10 g

Weight: 40 g

Weight: _____ g

Weight: _____ g

Front Belt Position: Right Left

Tire

Tire	Comments
Xenon	Controlled tire
Xenon	-----
Xenon	-----
1st: Corally	2nd: _____

Others

Motor	ORION 2009 4.5T	2nd Gear Ratio: 1.83
Pinion/Spur	<u>24</u> / <u>116</u>	Gear Ratio <u>8.84</u>
Battery	ORION Lipo 5400 45C	ESC <u>SXX TC Speck (1-4-2-2)</u>
Body	Speed6 Light Weight	Wing <u>Std</u>

Track Condition

<input checked="" type="checkbox"/> Smooth	<input type="checkbox"/> Asphalt
<input type="checkbox"/> Bumpy	<input type="checkbox"/> Concrete
<input type="checkbox"/> Low Truction	<input checked="" type="checkbox"/> Carpet
<input checked="" type="checkbox"/> Med. Truction	<input checked="" type="checkbox"/> Indoor
<input type="checkbox"/> High Truction	<input type="checkbox"/> Outdoor

Comment: Weight 1410g