

この度は、T-FHSS Mini-Z方式、京商Mini-Z Evo専用受信機 RA-42をお買い上げいただきまして誠にありがとうございます。ご使用の前に、本書ならびにご使用の送信機、車体の取扱説明書をお読みの上、正しく安全にお使いください。また、お読みになられた後も大切に保管してください。この受信機は京商Mini-Z Evo対応の送信機と組み合わせてのみ使用できます。送信機は京商Mini-Z Evo専用システムに切替えて使用します



●この受信機はFutaba 2.4GHz T-FHSS Mini-Z Evo 専用システム送信機のみに対応します。

(2019年3月現在: T7PX/T7XC Ver4.0~/T4PM Ver.1.0~)

●対応送信機をFutabaのHPにて最新Verにアップデートしてからご使用ください。アップデートの内容はHPをご覧ください。

※その他のシステムでは使用できません。また、テレメトリーは非対応です

RA-42

表

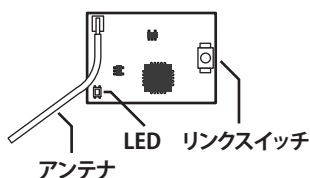

LED リンクスイッチ

アンテナ

裏

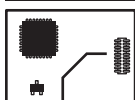

接続コネクタ

LED

点灯	正常
点滅	リンクなし
消灯	電源OFF

受信機基板の接続

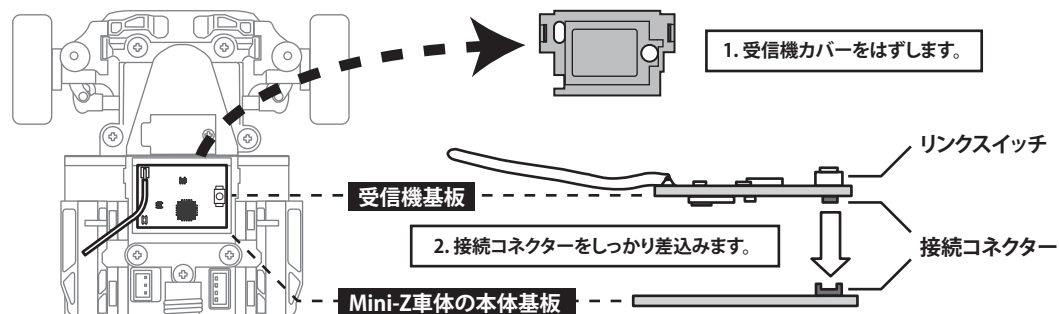

1. 受信機カバーをはずします。

2. 接続コネクタをしっかりと差込みます。

Mini-Z車体の本体基板

！電子部品は静電気に弱いため、触れないように作業してください。

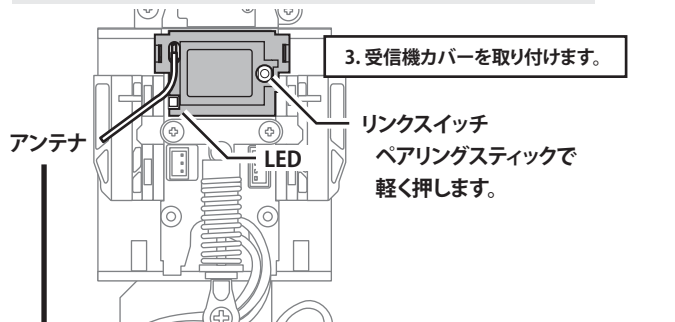

3. 受信機カバーを取り付けます。

リンクスイッチ
ペアリングスティックで
軽く押します。

リンクの方法

1 送信機と受信機(車体)を50cm以内に近づけます。

※アンテナ同士をできるだけ近接します。

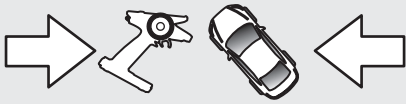

2 送信機/受信機の電源をONします。

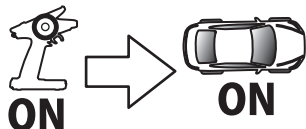

3 送信機を取扱説明書にしたがってリンクモードにします。



4 受信機のリンクスイッチを2秒以上押した後、離し、LEDが2秒点灯ののち、再度点滅したら、送信機のリンクモードを解除し、通常モードにしてください。

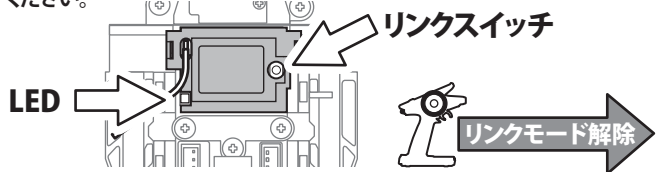

5 受信機のLEDが点灯したら成功です。

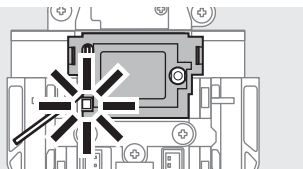

※リンク操作時、周囲で他のT-FHSS Mini-Zシステムがリンク操作されている場合、それらの送信機の中の1台とリンクしてしまう場合があります。このため、リンク操作が完了したら、必ず動作を確認してください。

アンテナは外部に出します。

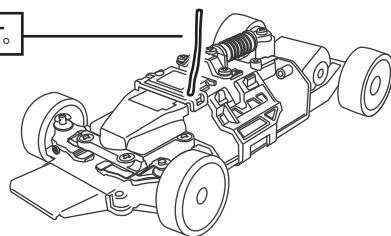

△ 注意

- この受信機は京商Mini-Z Evo専用です。その他の用途で使用してはいけません。
- アンテナを切ったり収納したりしないでください。
- ！ 本説明書のほかに、送信機、車体の取扱説明書をよく読んでそれに従ってご使用ください。
- ！ リンク操作が完了したら、一旦車体の電源をOFFとし、リンクした送信機をON、車体電源を再度ONして操作できることを確認してください。

RA-42仕様

京商Mini-Z Evo専用受信機
受信周波数: 2.4GHz 帯
システム: Futaba T-FHSS Mini-Z
使用電源電圧: 3.3V(車体側メインボードより供給)
サイズ: 14x20mm
重量: 0.9g

お問い合わせ先 京商 ユーザー相談室
243-0021 神奈川県厚木市岡田3050番地厚木アクストメインタワー7階
TEL:046-229-4115 FAX:046-229-4032
受付時間:月曜～金曜日(祝祭日を除く) 13:00～18:00 FAXは24時間

Thank you for purchasing the Mini-Z Evo receiver RA-42. This receiver is designed for use with the Kyosho Mini-Z Evo and Futaba T-FHSS Mini-Z system transmitter.

- **Note:** This receiver is designed to be used only for Kyosho Mini-Z Evo.
- **Note:** This receiver is compatible with the Futaba T-FHSS Mini-Z system transmitters. The transmitter also needs to be updated to latest version. (As of March 2019: T7PX/T7XC Ver4.0~/T4PM Ver1.0~)

*Futaba T-FHSS Mini-Z system does not work with other communication systems.

*This receiver is T-FHSS system, but the telemetry function isn't equipped.

RA-42

Top Side

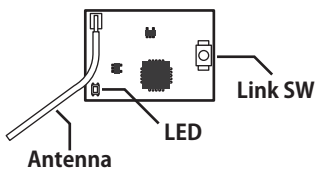

Bottom Side

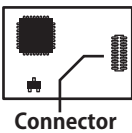

LED Indication

Solid	Link
Blink	No link
Lights off	OFF

Link Procedure

- 1 Bring the transmitter and the receiver close to each other, within 20 inches (half meter).

- 2 Turn on the transmitter. Place the transmitter into the receiver linking mode.
*Refer to the transmitters operation manual for complete details on how to place the transmitter into the linking mode.

- 3 Turn on the receiver. **ON**

- 4 Press Link SW on the receiver for 2 seconds or more.

- 5 Release the Link SW.
LED 2 seconds solid → Blink

- 6 Release the link mode of the transmitter. Completed with LED solid on the receiver.



* If there are many T-FHSS Mini-Z systems turned on in close proximity, your receiver might have difficulty establishing a link to your transmitter. This is a rare occurrence. However, should another T-FHSS Mini-Z transmitter/receiver be linking at the same time, your receiver could link to the wrong transmitter. This is very dangerous if you do not notice this situation. In order to avoid the problem, we strongly recommend you double check whether your receiver is really under control by your transmitter.

Caution

- ⊘ This receiver is dedicated to Kyosho Mini-Z Evo. It can not be used for other purposes.
- ⊘ Don't cut or bundle the receiver antenna wire.
- ⚠ In addition to this manual, read the transmitter and Mini-Z manual and follow it.
- ⚠ When the linking is complete, please cycle the receiver power and ensure the receiver is properly linked to the transmitter.

Receiver Mounting

1. Remove the receiver cover.

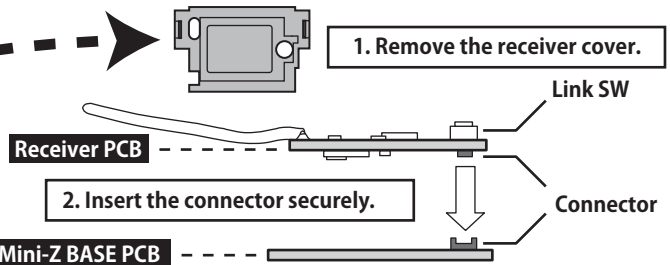

2. Insert the connector securely.

⚠ Since electronic components are sensitive to static electricity, work so as not to touch them.

3. Install the receiver cover.

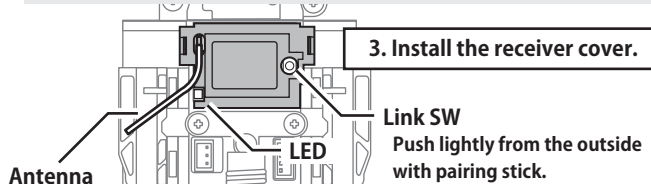

Place the antenna outside the car.

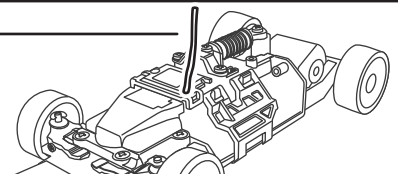

Compliance Information Statement (for U.S.A.)

This device, trade name Kyosho Corporation, model number RA-42, complies with part 15 of the FCC Rules. Operation is subject to the following two conditions:
(1) This device may not cause harmful interference, and
(2) This device must accept any interference received, including interference that may cause undesired operation.

The responsible party of this device compliance is:

<Kyosho America>

20322 Valencia Circle Lake Forest, CA. 92630-8158 US

(1)949 454 8854

<Kyosho Japan>

Atsugi AXT Main Tower 7F 3050 Okata Atsugi, Kanagawa 243-0021 JAPAN

(81)46 229 1511

FEDERAL COMMUNICATIONS COMMISSION INTERFERENCE STATEMENT

This equipment has been tested and found to comply with the limits for a Class B digital device, pursuant to Part 15 of the FCC Rules. These limits are designed to provide reasonable protection against harmful interference in a residential installation. This equipment generates, uses and can radiate radio frequency energy and, if not installed and used in accordance with the instructions, may cause harmful interference to radio communications. However, there is no guarantee that interference will not occur in a particular installation. If this equipment does cause harmful interference to radio or television reception, which can be determined by turning the equipment off and on, the user is encouraged to try to correct the interference by one or more of the following measures:

- Reorient or relocate the receiving antenna.
- Increase the separation between the equipment and receiver.
- Connect the equipment into an outlet on a circuit different from that to which the receiver is connected.
- Consult the dealer or an experienced radio/TV technician for help.

Compliance Information Statement (for Canada)

CAN ICES-3(B)/NMB-3(B)

Compliance Information Statement (for EU)

Declaration of Conformity

Hereby, Kyosho Corporation declares that the radio equipment type RA-42 is in compliance with Directive 2014/53/EU. The full text of the EU declaration of conformity is available at the following internet address:
<http://kyosho.com/eng/support/doc/index.html>

<KYOSHO CORPORATION>

Atsugi AXT Main Tower 7F, 3050 Okata Atsugi, Kanagawa, JAPAN 243-0021



RA-42 Specifications

Futaba/Kyosho Mini-Z Evo receiver
System: T-FHSS Mini-Z
Size: 0.55x0.79in (14x20mm)
Frequency band: 2.4GHz band
Power requirement: 3.3V(Supplied from Mini-Z BASE PCB)
Weight: 0.03oz (0.9g)